



AIRHYPE COMPACT

HIGH-SPEED HAIR DRYER
USER MANUAL

csteam@tymo-tech.com



Thank you for choosing TYMO AIRHYPE COMPACT High-Speed Hair Dryer. Please read this user manual carefully before you start.

IMPORTANT SAFETY INSTRUCTIONS

When using electrical appliances, especially when children are present, basic safety precautions should always be followed, including the following:

READ ALL INSTRUCTIONS BEFORE USING

KEEP AWAY FROM WATER

DANGER – As with most electrical appliances, electrical parts are electrically live even when the switch is off.

To reduce the risk of death by electric shock:

1. Always "unplug it" immediately after using.
2. Do not use it while bathing.
3. Do not place or store appliances where they can fall or be pulled into a tub or sink.
4. Do not place in or drop into water or other liquids.
5. If an appliance falls into the water, "unplug it" immediately. Do not reach into the water.

WARNING – To reduce the risk of burns, electrocution, fire, or injury to persons:

1. An appliance should never be left unattended when plugged in.
2. Close supervision is necessary when this appliance is used by, on, or near children or individuals with certain disabilities.
3. Use this appliance only for its intended use as described in this manual. Do not use attachments not recommended by the manufacturer.
4. Never operate this appliance if it has a damaged cord or plug, if it is not working properly, or if it has been dropped, damaged, or dropped into water. Return the appliance to a service center for examination and repair.
5. Keep the cord away from heated surfaces. Do not wrap the cord around the appliance.
6. Never block the air openings of the appliance or place it on a soft surface, such as a bed or couch, where the air openings may be blocked. Keep the air openings free

of lint, hair, and the like.

7. Never use while sleeping.

8. Never drop or insert any object into any opening or hose.

9. Do not use outdoors or operate where aerosols (spray) products are being used or where oxygen is being administered.

10. Do not use an extension cord with this appliance.

11. Do not direct hot air toward eyes or other heat sensitive areas.

12. Attachments may be hot during use. Allow them to cool before handling.

13. Do not place the appliance on any surface while it is operating.

14. While using the appliance, keep your hair away from the air inlets.

15. Do not operate with a voltage converter.

SAVE THESE INSTRUCTIONS

This appliance has a polarized plug (one blade is wider than the other). As a safety feature, this plug will fit in a polarized outlet only one way. If the plug does not fit fully in the outlet, reverse the plug. If it still does not fit, contact a qualified electrician. Do not attempt to defeat this safety feature.

This appliance is not intended for use by persons (including children) with reduced physical, sensory or mental capabilities, or lack of experience and knowledge, unless they have been given supervision or instruction concerning use of the appliance by a person responsible for their safety. Children should be supervised to ensure that they do not play with the appliance.

If the SUPPLY CORD is damaged, it must be replaced by the manufacturer, its service agent or similarly qualified persons in order to avoid a hazard.

CAUTION: In order to avoid a hazard due to inadvertent resetting of the THERMAL CUT-OUT, this appliance must not be supplied through an external switching device, such as a timer, or connected to a circuit that is regularly switched on and off by the utility.

WARNING: Do not use this appliance near bathtubs, showers, basins or other vessels containing water.



- when the appliance is used in a bathroom, unplug it after use since the proximity of water presents a hazard even when the appliance is switched off;
- for additional protection, the installation of a residual current device (RCD) having a rated residual operating current not exceeding 30 mA is advisable in the electrical circuit supplying the bathroom. Ask your installer for advice.

⚠ WARNING

THESE WARNINGS APPLY TO THE APPLIANCE, AND ALSO WHERE APPLICABLE TO ALL TOOLS, ACCESSORIES, CHARGERS OR MAINS ADAPTORS. TO REDUCE THE RISK OF FIRE, ELECTRIC SHOCK, OR INJURY:

- 1.This appliance can be used by children aged from 8 years and above and persons with reduced physical, sensory or reasoning capabilities, or lack of experience and knowledge, only if they have been given supervision or instruction by a responsible person concerning use of the appliance in a safe way and understand the hazards involved. Cleaning and user maintenance shall not be made by children without supervision.
- 2.Do not allow it to be used as a toy. Close attention is necessary when used by or near children. Children should be supervised to ensure that they do not play with the appliance.
- 3.If the supply cable is damaged, it must be replaced or repaired by the manufacturer, its service agent or similarly qualified persons in order to avoid a hazard.
- 4.This appliance has a non-self resetting thermal cut out safety device to prevent overheating. If your appliance cuts out, unplug it from the mains supply socket and leave to cool.
- 5.WARNING: Do not use this appliance near bathtubs, showers, basins or other vessels containing water.
- 6.Do not handle any part of the plug or appliance with wet hands.
- 7.Do not unplug by pulling on the cable. To unplug, grasp

the plug, not the cable. The use of an extension cable is not recommended.

8. Do not stretch the cable or place the cable under strain. Keep the cable away from heated surfaces and do not wrap the cable around the appliance.

9. Do not use any lubricants, cleaning agents, polishes or air fresheners on any part of the appliance.

10. Contact the TYMO Customer Services Team when a service or repair is required. Do not disassemble the appliance as incorrect reassembly may result in an electric shock or fire.

11. If the appliance is not working as it should, if it has received a sharp blow, if it has been dropped, damaged, left outdoors, or dropped into water, do not use and contact the TYMO Customer Services Team.

12. When the appliance has been unpacked, check it if it has transport damage and ensure that all parts have been delivered. If parts are missing or the appliance has been damaged, please email the TYMO Customer Services Team.

13. If the appliance does not work, or is not working properly, please email the TYMO Customer Services Team. DO NOT attempt to repair the appliance. Repair work by the unqualified persons can cause serious risk to the user and will void the warranty.

14. ~ The symbol indicates AC voltage.



RECYCLING

This product bears the selective electrical and electronic equipment (WEEE). This means that this product must be handled pursuant to European directive 2012/19/EU in order to be recycled or dismantled to minimize its impact on the environment. User has the choice to give his product to a competent recycling organization or to the retailer when he buys a new electrical or electronic equipment.

This product can be used across EU member states.

Specifications

Name: High-Speed Hair Dryer

Model: HC603P

Power Supply(US): 100V-120V~ 50/60Hz

Rated Power: 1500W

Power Supply(UK、EU、PH、HK、PH、MY、SG、TH、VN、INA): 220V-240V~ 50/60Hz

Rated Power: 1600W

BLDC High-speed Digital Motor: 110000rpm

Negative Ion: 200M ions/cm³

Packaging List

Packaging List	Quantity
High-Speed Hair Dryer	1
Magnetic Smoothing Nozzle	1

Product Overview

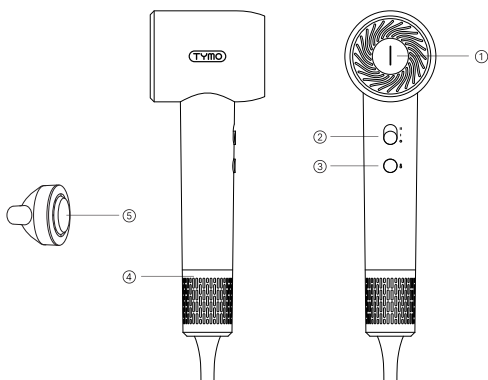

- ① Temperature Indicator
- ② On/Off Switch

- ③ Temperature Control Button
- ④ Air Intake
- ⑤ Magnetic Smoothing Nozzle

How to Use

- (1) Connect the power supply and slide the On/Off Switch to the first position and turn on the device.
- (2) Continue sliding the On/Off switch to adjust the wind speed as desired.
- (3) Press the temperature control button to select room, low, medium or high temperature settings.
- (4) Press and hold the temperature control button for a cool burst of air. Release the button, the device will return to the previous temperature setting.

Wind Speed



Gentle



Fast

Temperature Setting



Room
temperature
(light off)



060°C/140°F
(white light)



080°C/180°F
(yellow light)



100°C/210°F
(orange light)

Cool Shot



Press and hold



Light off

△NOTE

- Maximum operating temperature in normal working conditions: up to 210 °F (100 °C)
- Maximum thermistor temperature at safety shut down: 300°F (150°C)

Compact robust design

Ultra-lightweight hair dryer at only 380 grams, compact and robust, ergonomic and easy to use.

High powered performance

110,000-rpm BLDC high-speed motor producing high-speed airflow of 23m/s and high-volume airflow of 20L/s, and the lowest noise is only 69dB

Magnetic styling nozzle

Magnetically-secured nozzle, double-layer anti-scalding design, easy to handle styling



⚠ Warning:

The air exit, metal ring and attachments may be hot during use.

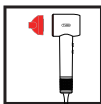

⚠ Warning:

THE APPLIANCE, NOZZLE CONTAIN MAGNETS.

1. Please keep away from pacemakers, defibrillators, credit cards and electronic storage media.

ALCI safety (U.S. only)

ALCI OPERATION Electricity flickers or trips the circuit breaker during use.

This High-Speed Hair Dryer is equipped with an Appliance Leakage Circuit Interrupter (ALCI), a safety feature that renders it inoperable under abnormal conditions. Should the dryer turns off in use, press the red Reset button on the plug and the dryer should function normally. If the dryer does not reset, please check your circuit breaker. If the issue persists, ensure there are no other appliances plugged in within the room where the dryer is being used. Do not use the High-Speed Hair Dryer with a power strip.

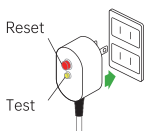

The reset button will 'click' and pop out.
If running, the machine will stop working.



To test: Plug in the machine and press the 'Test' button.



To reset the ALCI, unplug and press 'Reset' button and plug back in.

How to Clean

To ensure optimal performance and maintenance of the High-Speed Hair Dryer, it is recommended to regularly clean the air intake.

(1)Auto-cleaning Mode

The High-Speed Hair Dryer is equipped with auto-cleaning mode. To activate this mode, press and hold the temperature control button while sliding the On/Off switch to the II wind speed.

The auto-cleaning mode will begin and the hair dryer will automatically turn off once the cleaning is complete.

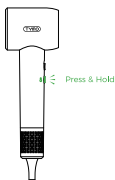

①

Press and hold the temperature control button

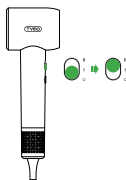

②

Slide the On/Off switch to the II wind speed

(2) Manual Cleaning

Turn off the device and unplug it from power supply before cleaning.

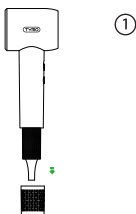

①

Pull down on the air intake cover.

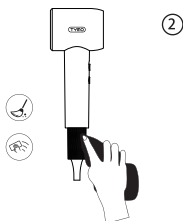

②

Use a new toothbrush to brush away any dust or debris on the filter.



Do not use water to clean the filter.

Do not apply too much pressure to the filter mesh.

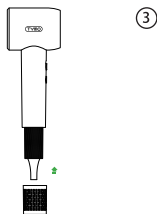

③

After cleaning, push the air intake cover back up until it clicks into place.

Safety Maintenance

1. Do not touch the heated surface without using the heat proof glove.
2. Never operate this appliance if there is any damage to the cable or plug.
3. Always unplug the device immediately and store in a safe, dry location after use.
4. The appliance is non-waterproof, please do not use it in a humid environment.
5. Do not leave the appliance alone when it is working, please keep away from children.
6. This appliance should not be used by children and individuals with certain disabilities or lack of experience and knowledge, unless they have been given supervision or instruction concerning use of the appliance by a person responsible for their safety.

FCC Statement

This device complies with Part 15 of the FCC Rule. Operation is subject to the following two conditions:
(1) This device may not cause harmful interference, and
(2) This device must accept any interference received, including interference that may cause undesired operation.

WARNING

Changes or modifications to this unit not expressly approved by the party responsible for compliance could avoid the user's authority to operate the equipment.

NOTE:

This equipment has been tested and found to comply with the limits for a Class B digital device, protection against harmful interference in a residential installation. This equipment generates, uses and can radiate radio frequency energy and, if not installed communications. However, there is no guarantee not occur in a particular installation. If this interference will equipment does cause harmful interference to radio or television reception, which can be determined by turning the equipment off and on, the user is encouraged to try to correct the interference by one or more of the following measures:

- Reorient or relocate the receiving antenna.
- Increase the separation between the equipment and receiver.
- Connect the equipment to an outlet on a circuit different from that to which the receiver is connected.
- Consult the dealer or an experienced radio/TV technician for help.

Warranty

The product warranty is governed by regulations in force and applied upon showing the original legible purchase receipt complete of all its parts. For support service under warranty, please take the original purchase receipt to the store where the product was purchased or contact customer service at csteam@tymo-tech.com.

Trouble shooting

Error code	Cause	Solution
E01	Under-voltage protection	Use the correct voltage
E02	Over-voltage protection	Use the correct voltage
E03	Over-current protection	Clean the air intake screen

Flashing



E01



E02



E03

The above is only a description of some potential faults, If you cannot resolve any issue effectively, please contact customer service at csteam@tymo-tech.com.



www.tymobeauty.com



@tymo



@tymo_fashiontech